



INSTALLATION INSTRUCTIONS
Frame Skid Plate Kit
18P-F84N0-V0
2009 YFZ450R

**WARNING**

Please read and understand these instructions completely before installation to avoid possible injury to yourself or damage to the accessory or vehicle.

CAUTION:

This installation should be performed by an authorized Yamaha dealer or a qualified mechanic. Some components require information from the Model's Service Manual for proper installation or adjustment. Be sure to have the Service Manual on hand, if necessary, before proceeding with the installation.

DEALER:

These instructions contain important information for future reference and *must* be given to the customer.

WARRANTY INFORMATION:

- Genuine Yamaha accessories are covered by a 90-day warranty against defects in material or workmanship. Labor for replacement of defective components is not covered. See your Yamaha dealer for a copy of the warranty statement.
- The Limited Warranty provided with new Yamaha vehicles has exclusions for certain failures, including those caused by competition or racing use (except YZ and WR motorcycle models) as well as by abnormal strain or abuse. While installation of these components will not "void" your vehicle's warranty, specific failures adjudged by Yamaha to have resulted from the installation of accessory components or other modifications, or from competition use (except YZ and WR motorcycle models), may not be covered by warranty or Yamaha Extended Service.

PARTS LIST:

This kit contains the following components. Before beginning installation, confirm there are no missing or damaged components.

| Item | Part Number | Description | Qty |
|------|--------------|-----------------------------------|-----|
| -- | 18P-F84N0-V0 | Frame Skid Plate Kit | -- |
| ① | * | Skid Plate | 1 |
| ② | * | Hook | 2 |
| ③ | * | Aluminum Bracket | 1 |
| ④ | * | Flange Bolt (M6 x 1.0 x 16mm lg) | 8 |
| ⑤ | * | Flange Bolt (M8 x 1.25 x 25mm lg) | 2 |
| ⑥ | * | Plain Washer | 2 |
| ⑦ | * | Locking Nut (M6) | 2 |

* Part supplied with kit only and not available separately.

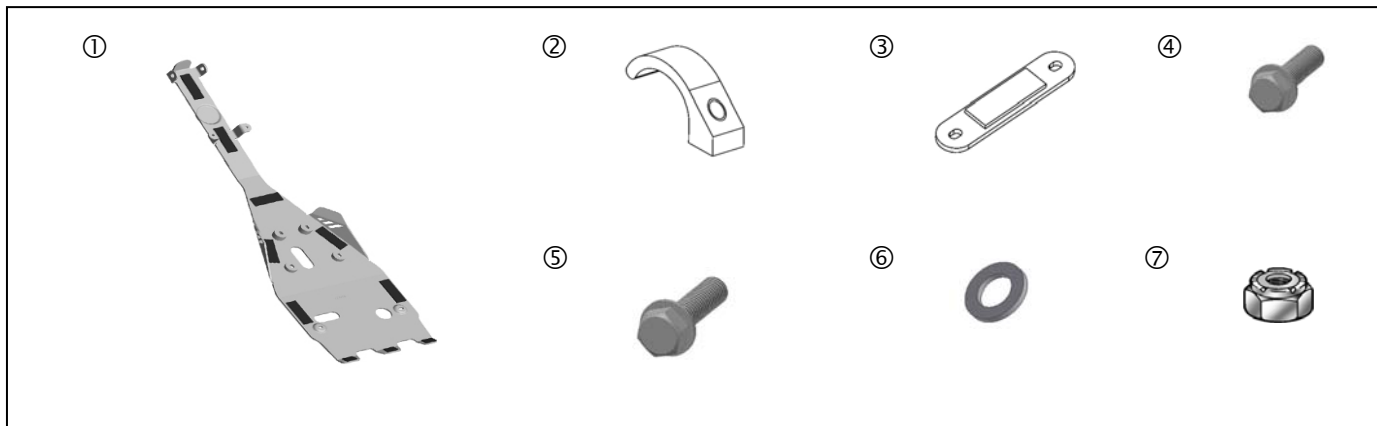

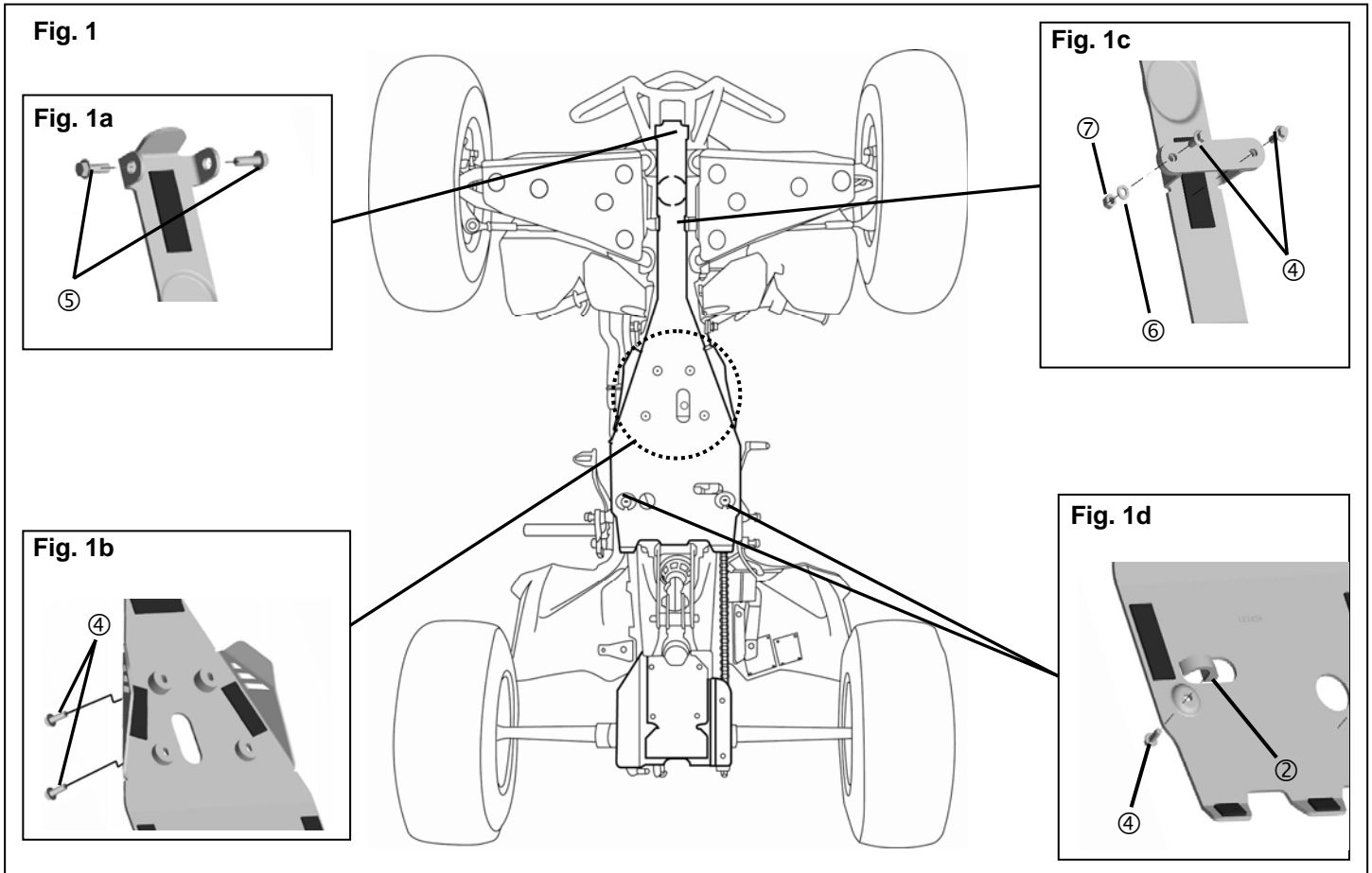

PREPARATION:

1. Place ATV on a secure level surface and set the parking brake.
2. Clean all mounting surfaces before beginning installation.
3. Turn the gas petcock to the "OFF" position and stand the ATV upright on the rear grab bar.
4. Remove two bolts securing the lower bracket of the front grab bar to the frame (refer to Service Manual).
5. Remove the stock skid plate. Store all hardware as it will not be reused.

WARNING

Be sure the ATV is stable before beginning work. You could be injured if it falls over. Be sure the fuel cap is tightened securely. Leaking fuel is a fire hazard.

INSTALLATION:

1. Place frame skid plate ① onto underside of the ATV.
2. Align the upper mounting holes with the lower mounting brackets on front grab bar and secure in place using two M8 (25mm) flange bolts ⑤. Do not tighten bolts at this time and make sure the front grab bar rests between the skid plate and the frame (Fig. 1a)

3. Secure the center section of the skid plate using four M6 flange bolts ④ as shown in Figure 1b.
4. Install the aluminum bracket from the top and secure in place using the M6 flange bolts ④, the plain washers ⑥ and the locking nuts ⑦ as shown in Figure 1c.
5. Install the hooks ② using the M6 flange bolts ④ as shown in Figure 1d. Apply Loctite® 242 to each bolt before threading them into the hooks.
6. Torque all M6 flange bolts to 15 Nm (11 ft • lbs.)
7. Torque front grab bar bolts to 31 Nm (22 ft • lb).
8. Torque aluminum bracket bolts to 15 Nm (11 ft • lbs.).

MAINTENANCE:

Periodically, check all hardware for looseness and re-torque as required.

CARE AND CLEANING:

Clean using a soft cloth and a non-abrasive metal polisher, such as Simichrome Polish (P/N: ACC-1100-19-01).

CUSTOMER SERVICE:

For further information, see your Yamaha dealer.

ESTIMATED TIME TO INSTALL: 0.4 HRS